

4x4 and 5x5 STRUCTURAL PORCH POST

INSTALLATION INSTRUCTIONS

TOOLS REQUIRED:

- Chop/Mitre Saw with carbide tipped blade
- Tape measure
- Drill and drill bits
- Level

HELPFUL HINTS:

- Do not lay PVC parts on abrasive surfaces.
- Tapcon anchors are recommended for installation into concrete. (Not provided.)

1) Measure your opening height.

2) Using a chop saw, cut the length of the Porch Post Assembly (Exterior PVC Column, Filler Strips and Aluminum Support Tube) 1/2" shorter than your opening height.



3) Using a hand saw, cut **JUST** the PVC exterior column another 3/4" shorter.

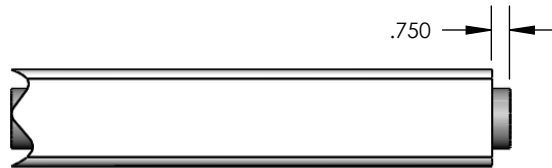

4) Fasten a Mounting Plate to one end of the Aluminum Support Tube using the (4) #10 x 1.000" screws provided. The screws should be installed in between the outside tabs.

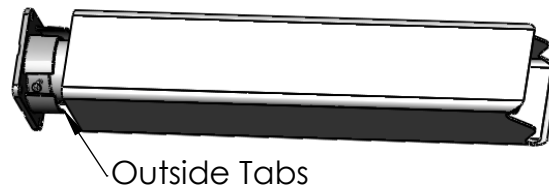

5) Push the Mounting Plate into the exterior PVC Column until it is flush as shown.

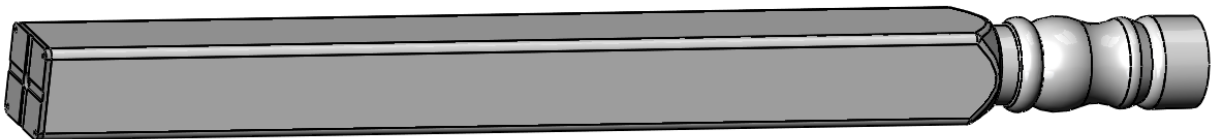

- 6) Attach the second Mounting Plate on the other end of the Aluminum Support Tube using the (4) #10 x 1.000" screws provided.

The sides of the two Mounting Plates must be parallel to each other as shown below.
(The external PVC Post has been removed for clarity.)



- 7) Cut a notch on the inner wall of (2) Post Skirts (not provided) as shown. This is required for screw head clearance in steps 14 and 15 below.

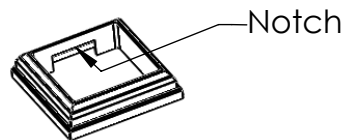

- 8) Slide a Post Skirt onto each end of the external PVC Column.
9) Install the Porch Post assembly in the desired opening location.
10) Rotate the exterior PVC Column 45 degrees to expose the mounting holes in the Mounting Plates.

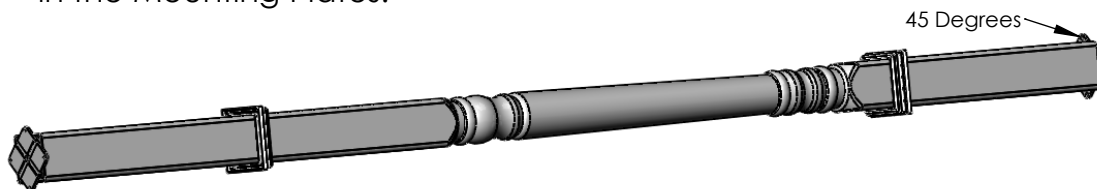

- 11) Level the Porch Post.
12) Fasten the Mounting Plates to the floor and ceiling using the appropriate fasteners (not provided).
13) Rotate the external PVC Column back into position.
14) Attach the PVC Column to each of the Mounting Plates using the (2) #10 x 1.000" screws provided.

Note: These screws need to be placed on the sides of the Column that have the notches in the Post Skirts.

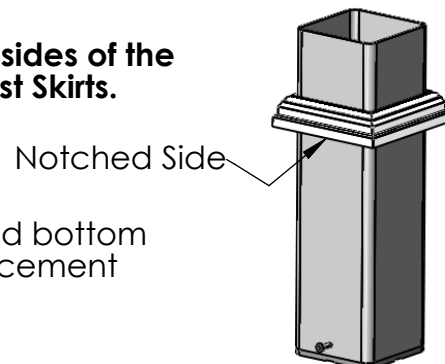

- 15) Slide the Post Skirts into position on the top and bottom of the post and glue them in place with PVC cement or silicone caulk.